

# SR-48 – Hard Wired Road Studs



<b>ADVANTAGES</b>		
<ul style="list-style-type: none"> <li>• High mechanical strength: 90 Tons</li> <li>• Ideal for areas with high snow fall; rising only 8.5mm from road surface</li> <li>• Steel or rubber tip proof</li> <li>• Day and night time brightness</li> <li>• 100% waterproof</li> <li>• LEDs with variable brightness</li> <li>• Hard wired mains power, optional solar &amp; battery</li> <li>• Option to connect to any input/output system</li> <li>• Easy replacement : Based (Fixed on the ground), Main Body (Removable)</li> </ul>	<ul style="list-style-type: none"> <li>• Low maintenance</li> <li>• Uni and Bidirectional operation</li> <li>• Multiple operation modes</li> <li>• Programmable functions</li> <li>• PC remote controlling</li> <li>• Communication protocol</li> <li>• Operating time programmable</li> </ul>	
<b>MODES OF OPERATION (24/7)</b>		
<ul style="list-style-type: none"> <li>• Constant (always on)</li> </ul>	<ul style="list-style-type: none"> <li>• Intermittent (flashing)</li> <li>• Sequential (strobing)</li> </ul>	
<b>Communication protocol Master/Slave</b>	Communication RS485 (Optional)	Communication CAN-BUS (Optional)



**REMA Nikkalite**

T: 01928 579 966 F: 01928 579 965 E: [uksales@rennicks.com](mailto:uksales@rennicks.com)

[www.rennicksuk.com](http://www.rennicksuk.com)

Registered in the United Kingdom No. 2101567 VAT No. GB 464 633633



**Rennicks** U.K.  
CLEARLY BETTER

<b>ELECTRICAL CHARACTERISTICS</b>					
<b>Power</b>	12 Vdc			24Vdc	
<b>LED Colour</b>	Amber	Red	White	Blue	Green
<b>Average consumption</b>	<b>160mA</b>				
<b>OPTICAL CHARACTERISTICS</b>					
<b>Number of LEDs</b>	16 LEDs 5mm				
<b>Type LED</b>	CREE 5mm		NICHIA 5mm		
<b>Colour LED</b>	Amber	Red	White	Blue	Green
<b>Viewing Angle</b>	15°	15°	15°	15°	15°
<b>Brightness Intensity</b>	Min: 8200mcd Max: 16800mcd	Min: 8200mcd Max: 16800mcd	Min: 22000mcd Max: 31000mcd	Min: 6960mcd Max: 9750mcd	Min: 15320mcd Max: 21650mcd
<b>STUD BODY</b>					
<b>Physical dimensions</b>	Diameter: 160.5mm Depth: 100.5mm Maximum rising from road surface: 8.5mm (centre of the parable) Installation depth: 95mm Visible surface: Diameter 160.5mm				
<b>Material</b>	Base – Aluminium Top – Stainless steel or Aluminium				
<b>Cap Treatment Options</b>	Standard treatment				
<b>Mechanical Resistance</b>	90 Tons				

Dimensions:

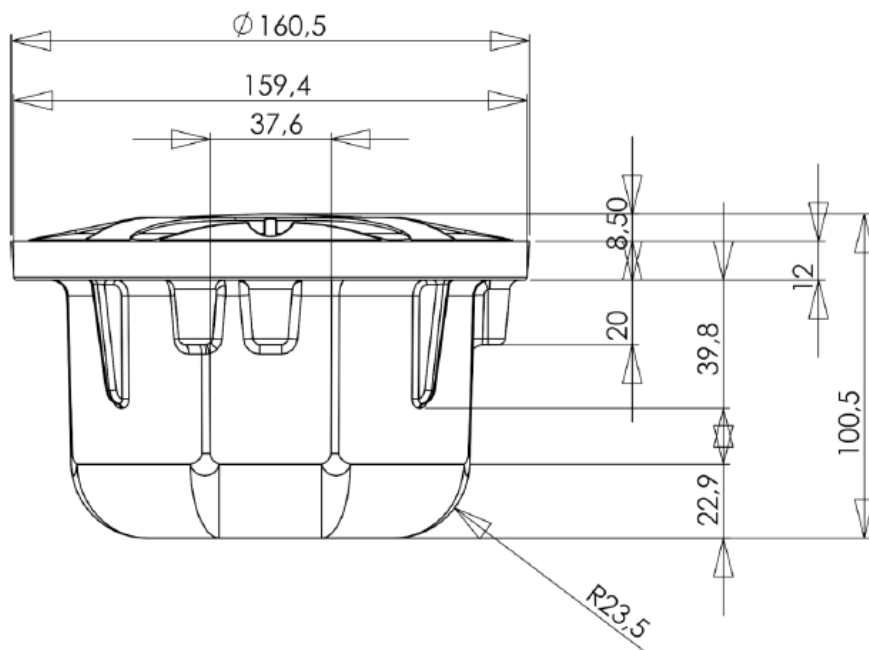
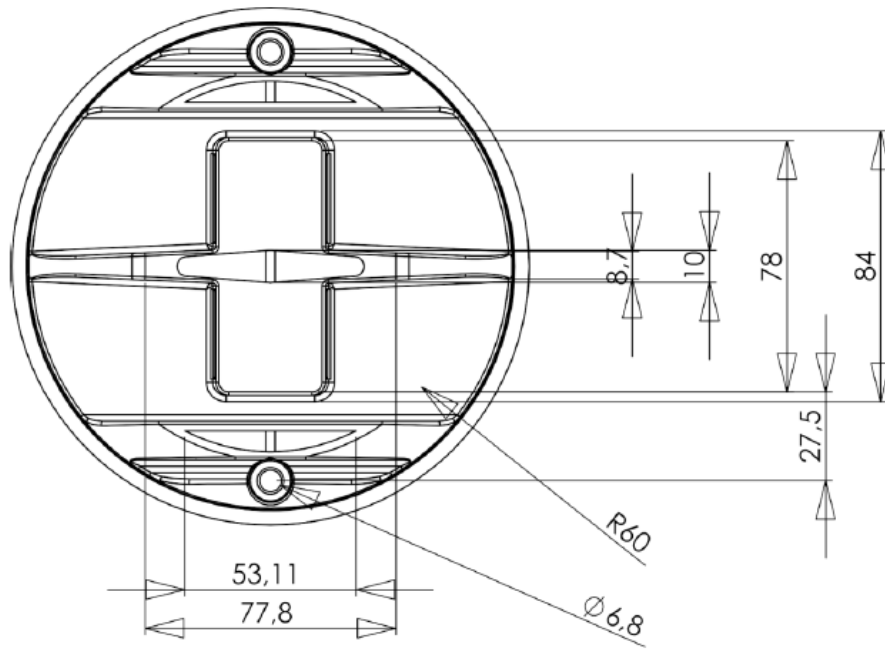

## INSTALLATION INTO CARRIAGEWAY

- As required by Traffic Signs Manual Chapter 5
- Sealing compound Triflex R238 (stud), Triflex R239 (cable) or Sikadur 42 (stud and cable); refer to the manufacturer's instructions for correct mixing and use.

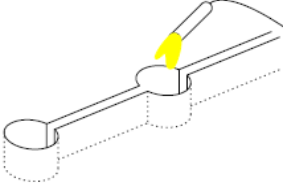
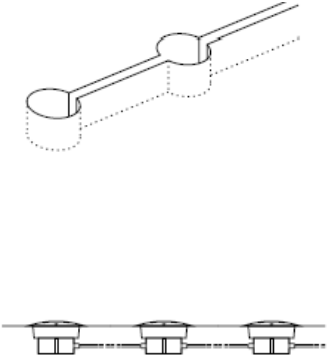
<ol style="list-style-type: none"> <li>1) Drill holes 95mm deep using a 162mm diameter bit.</li> <li>2) Open a connection between holes for the cabling; Width 25mm, Depth 65mm</li> <li>3) Remove all debris from inside and around the holes.</li> <li>4) Dry the holes using a blow torch.</li> </ol>	
<ol style="list-style-type: none"> <li>5) Place studs in the holes and connect the cabling</li> <li>6) Pour sealing compound into each hole to approximately 50% of depth.</li> <li>7) Orientate stud to direction of traffic and firmly press into hole.</li> <li>8) Gently tap top of stud with a rubber mallet to seat the stud correctly.</li> <li>9) Remove excess sealing compound.</li> <li>10) Ensure shoulder of stud rests on carriageway surface.</li> <li>11) Scoop up excess sealing compound from edges of stud.</li> <li>12) Ensure no sealing compound is on surface of stud.</li> <li>13) Fill cabling opening to specifier's instructions.</li> </ol>	
<ol style="list-style-type: none"> <li>14) Allow sealing compound to dry for approximately 1 hour before traffic over the studs.</li> </ol>	