

# SR-20C – Hard Wired Road Studs



<b>ADVANTAGES</b>					
<ul style="list-style-type: none"> <li>• Hard wired mains power, optional solar &amp; battery</li> <li>• Connects to any input or output system</li> </ul>			<ul style="list-style-type: none"> <li>• Uni or bidirectional LED operation</li> <li>• LED with variable brightness (Day/Night)</li> <li>• Auto sensor</li> <li>• Configurable</li> </ul>		
<b>OPERATION MODES (24/7)</b>					
<ul style="list-style-type: none"> <li>• Constant (always on)</li> </ul>			<ul style="list-style-type: none"> <li>• Intermittent (flashing)</li> <li>• Sequential (strobing)</li> </ul>		
<b>ELECTRICAL CHARACTERISTICS</b>					
<b>Voltage</b>	12 Vdc/24Vdc				
<b>LED Colour</b>	Amber	Red	White	Blue	Green
<b>Average consumption</b>	<b>Unidirectional 20mA</b>			<b>Bidirectional 40mA</b>	
<b>POWER CABLE</b>					
Brown (+)			Blue (-)		



**REMA Nikkalite**

T: 01928 579 966 F: 01928 579 965 E: [uksales@rennicks.com](mailto:uksales@rennicks.com)

[www.rennicksuk.com](http://www.rennicksuk.com)

Registered in the United Kingdom No. 2101567 VAT No. GB 464 633633



**Rennicks** U.K.  
CLEARLY BETTER

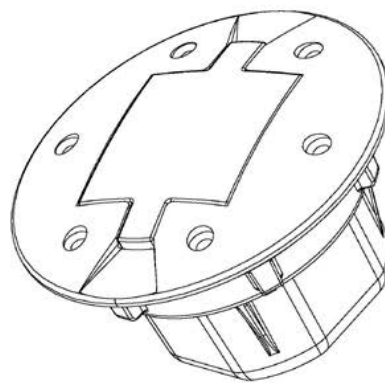
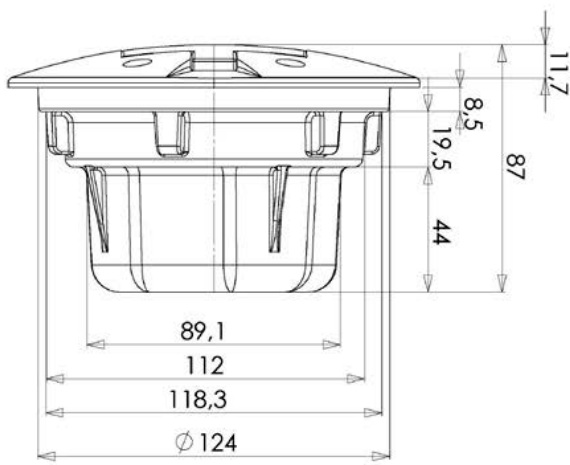
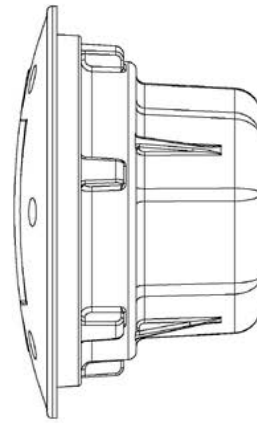
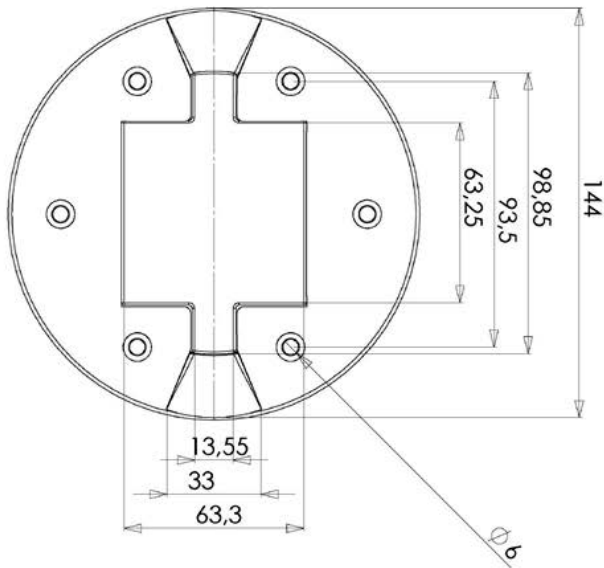

<b>OPTICAL CHARACTERISTICS</b>					
<b>Number of LEDs</b>	1 or 2 LEDs – Unidirectional 2 or 4 LEDs - Bidirectional				
<b>Type LED</b>	CREE 5mm		NICHIA 5mm		
<b>Colour LED</b>	Amber	Red	White	Blue	Green
<b>Viewing Angle</b>	15°	15°	15°	15°	15°
<b>Brightness Intensity</b>	Min: 8200mcd Max: 16800mcd	Min: 8200mcd Max: 16800mcd	Min: 22000mcd Max: 31000mcd	Min: 6960mcd Max: 9750mcd	Min: 15320mcd Max: 21650mcd
<b>STUD BODY</b>					
<b>Physical dimensions</b>	Diameter: 144mm Depth: 87mm Rising from road surface: 14.7mm (centre of the parable) Installation depth: 80mm Visible surface: Diameter 144mm				
<b>Aluminium top surface finishes</b>	<b>Surface Options</b>		<b>Code</b>		
	Brushed aluminium		Standard		
	Pedestrian area anti-skid		AS		
	Hard anodizing		HA		
	Architectural polished		P		
<b>Mechanical Resistance</b>	20 Tons				



REVISION	
DATE	
DESIGNER	
CHECKER	
APPROVER	
<b>SR-20 TOTAL F</b>	
A2	

**INSTALLATION INTO CARRIAGEWAY**

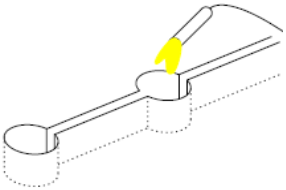
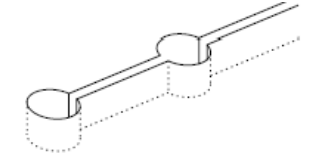
- As required by Traffic Signs Manual Chapter 5
- Sealing compound Triflex R238 (stud), Triflex R239 (cable) or Sikadur 42 (stud and cable); refer to the manufacturer’s instructions for correct mixing and use.

<ol style="list-style-type: none"> <li>1) Drill holes 80mm deep using a 130mm diameter bit.</li> <li>2) Open a connection between holes for the cabling; Width 25mm, Depth 65mm</li> <li>3) Remove all debris from inside and around the holes.</li> <li>4) Dry the holes using a blow torch.</li> </ol>	
<ol style="list-style-type: none"> <li>5) Place studs in the holes and connect the cabling</li> <li>6) Pour sealing compound into each hole to approximately 50% of depth.</li> <li>7) Orientate stud to direction of traffic and firmly press into hole.</li> <li>8) Gently tap top of stud with a rubber mallet to seat the stud correctly.</li> <li>9) Remove excess sealing compound.</li> <li>10) Ensure shoulder of stud rests on carriageway surface.</li> <li>11) Scoop up excess sealing compound from edges of stud.</li> <li>12) Ensure no sealing compound is on surface of stud.</li> <li>13) Fill cabling opening to specifier’s instructions.</li> </ol>	 
<ol style="list-style-type: none"> <li>14) Allow sealing compound to dry for approximately 1 hour before traffic over the studs.</li> </ol>	